



FIRE ALARM SYSTEM



FIREGUARD GLOBAL LTD.

Tel: 00-44-8450751042 • Fax: 00-44-8459751043
Email: Info@Fireguard-Uk.com • www.fireguard-Uk.com

Unit 11 • Chancel Industrial Estate • Newhall Street
Willenhall • WV13 1NX • United Kingdom



FS546607



EN54 Approved

Custom Colors



FG901CP_AP

1 loop expandable to 9 addressable fire alarm control panel

EN 900 series Model FG901CP_AP, is the fire alarm control panel of the future generation with touch-screen technology and certified to EN 54-2 and 4. The GUI interface is user friendly, you can program the panel without a manual. With its minimal set-up it is able to manage open or closed loops of 240 compatible devices. Basic configuration can be expanded adding two loops each time to control up to 2160 devices, both optical and thermal, from a single control panel. In complex applications, it can be installed in a ring network (up to 128 control panels). In this distributed architecture, areas and zones can be monitored by detectors and they can be combined by means of logical expressions in order to trigger events for the panel to which they belong or for other panels of the ring network. With the installation of dedicated cards, it is also possible to connect the control panel to external peripheral, such as keyboards and LED panels.

Certified to UNI EN 54-2 e 54-4 for fire detection, this control panel provides three different access levels according to the

user (installer, safety responsible and final user). The touch interface, simple and ergonomic, permits to any user to interact intuitively without training time and costs. The configuration procedure is immediate, autoprogramming and auto-addressing mechanisms allow to recognize, consult and program the devices on the field in a fast, systematic and correct way.

The control panel can be programmed locally or from remote, by means of the dedicated online platform OneCloud, data can be exported and imported with any USB key. Monitoring is made possible thanks to WINWATCH32 supervision system.

Detectors and devices diagnostics are carried on directly from the control panel, and a single operator is able to perform autonomously all the test procedures, and to check in plant operativity of all its components. Regular maintenance interventions can be optimally planned and executed.

Diagnostic data and historical data stored by the control panel can be easily exported and analyzed.

Control panel can be customized for any installation condition: colour, display background, programmable LED colour, logo displayed in welcome screen and the language can be selected as preferred.

HARDWARE features

- Addressable fire alarm panel with 32-bit microprocessor
- LCD touchscreen display (480x272 TFT 4.3")
- Back light on/off and three settable colors
- 1 addressable loop, expandable up to 9 loops (with 4 FG901LC_AP) configurable as open or closed
- Digital protocol
- Frontal LEDs with three settable color: white, blue and green
- each loop supports 240 addressable devices
- Short-cut circuit protection
- 14 front LED for events
- Silenceable and excludable signaling buzzer
- 1 monitored output for siren or dialer (24Vdc 1A)
- General Output dry contact 1A 30Vdc 120 Vac
- 1 general open collector output
- 1 RS 485 line for peripherals (maximum current value)
- 1 RS 232 and 1 micro USB for programming and remote management
- Ethernet card 10 Mbit/s (Optional PTLAN)
- 56 LED zone (option card FG90156LRD_AP)
- Ring Network Card between central (optional FG901NC_AP tab)
- Maximum 16 remote control panels can be connected to the RS485 BUS max 800m distance (FG901RP_AP)
- With four additional FG901LC_AP needed supplementary power supply (FGPower)
- Two 12 V Battery: capacity 17Ah each
- Automatic test of efficiency batteries and battery disconnection in case of deep discharge
- Auxiliary power output 24 Vdc 500mA with shortcut protection
- Dimensions: 410 x 410 x 120 mm
- Weight: 6,1Kg (without batteries)
- Power supply: 230Vac
- Current absorption: 300mA
- Maximum current external loads: 500mA
- Operating Temperature: 0C°/ +50C°
- Maximum current on loop: 500mA

SOFTWARE features

- 240 addressable devices for one loop
- hybrid systems wired/radio
- 192 programmable zones
- 192 logic functions
- more than 1000 events reported into archive
- Internal clock
- Auto programming analog devices on loop
- Auto addressing analog devices on loop*
- Mapping analog devices on the loop
- Ring connection with other stations using a fault tolerant network
- Multilingual management
- Customizable with personal logo
- Management of detectors and analog modules of different types:
 - Managed Thermal and optical detectors in the sema loop
 - Input modules
 - Output Modules
 - Buttons addressed
 - Analogue Addressable Sirens multiprotocol
- Colorful LED selectable
- Programmable locally or remotely by dedicated software
- Multi - Protocol FIREGUARD and Fireguard
- MODBUS TCP/IP/MODBUS RTU protocol over IP (TCP option card FG901MD_AP)
- Certified Product Standards EN54-2 and EN54-4
- CE Marking (EMC low-voltage directive)

“FG901CP_AP, is the fire alarm control panel of the future, completely made in UK. First alarm control panel with touch-screen technology and certified EN 54-2 and 4.”

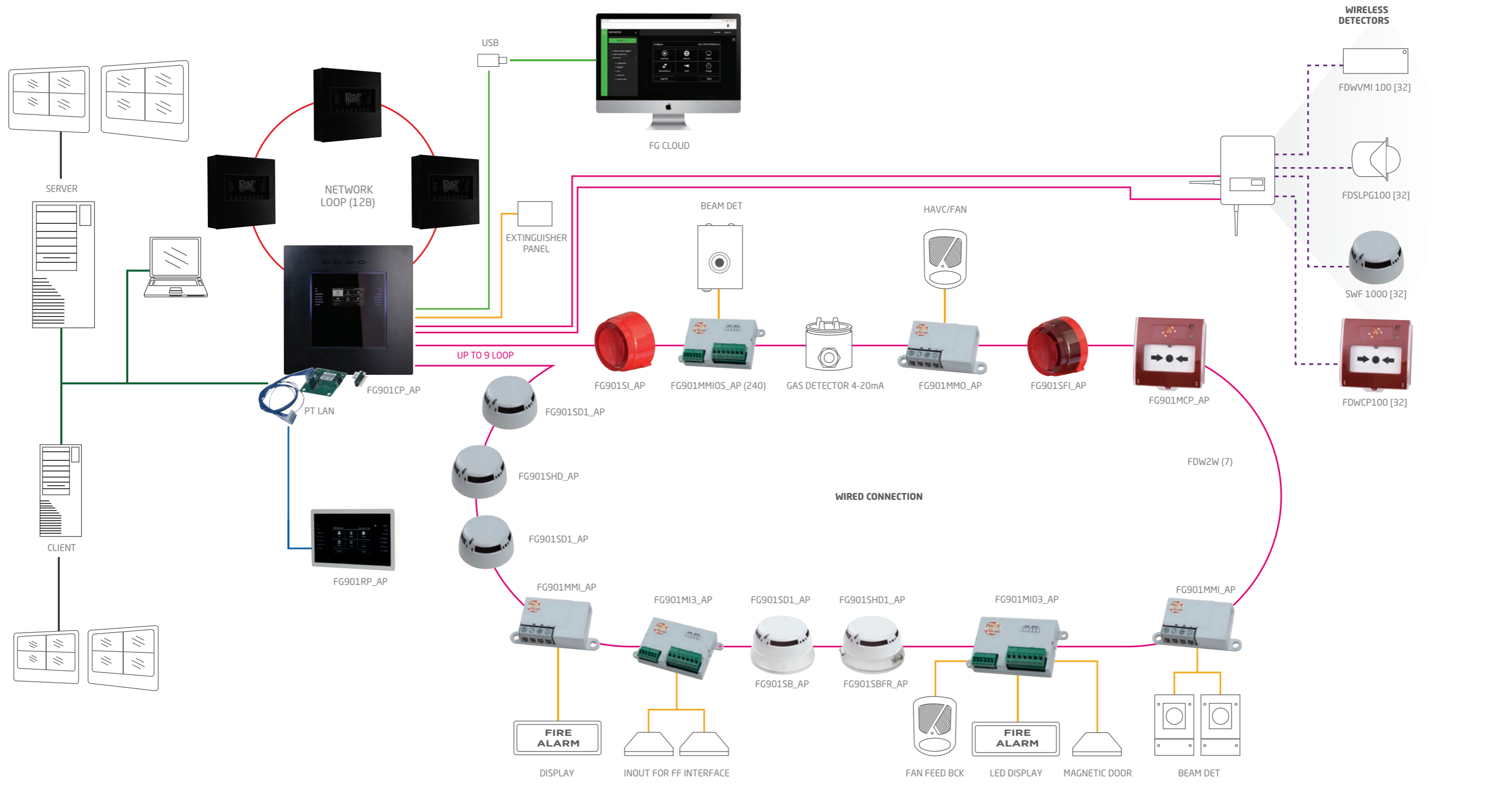

- **TCPIP NETWORK** (CAT5 cable)
- **RS485 LINE** (Shielded, ant flame cable with 2 connectors for power supply and 2 connectors RS484 for signal)
- **SIGNAL** (Shielded, ant flame cable with 2 connectors for power supply and 2 connectors RS484 for signal)
- **USB** (Upload download programmazione)
- **POWER SUPPLY AND SIGNAL** (Shielded, ant flame cable with 2 connectors for signal and power supply)
- - - **WIRELESS** (Radio connection with 870 MHZ Frequence)
- **NETWORK LOOP** (Cat 5 cable)
- **CLOSE LOOP WITH POWER SUPPLY** (Shielded, ant flame cable with 2 connectors for signal and power supply)
- (x)** = Maximum Number of connected device. The devices can be added tougher ex: (x) + (x)
- [x]** = Maximum Number of connected device. The device cannot be added tougher ex: (x) or (x)

Superior technology and ease of use make this system truly UNIQUE!

1. End User

For the first time in the fire industry, even the end-user can interact with a control panel! End-user can access to their own personal screen at any time, without a password, allowing them to see the events divided by: All, Alarms, Faults, Dates, Loop or by area. Or simply call assistance with a touch!

2. Log In

Once logged on the system, the end-user, maintenance technician or programmer will gain immediate access to his own user menu. Only the 4-6 keys specially designed for each user will appear on the touch screen! Everything is quick and easy: mistakes are virtually impossible! Finally a fire control panel that's easy-to-understand!

3. Operator Menu

Fireguard FG901CP_AP is a maintenance technician's dream. Traditional fire control panel force you to use conventional mini displays, often poorly back-lit, with endless menus, perhaps not even in your language, or require you to connect to a pc,

4. Diagnostic Map

Fireguard FG901CP_AP displays the status of the system in a single glance, thanks to its diagnostic map which provides full information: immediately visualizing detectors, input/output modules and all wireless devices market with a "W". The level of dust and consequent inefficiency of a detector is indicated with different colours.

5. Detailed Information

By touching the icon of the device, detailed information will appear about the exact percentage of dust, making it easier to plan periodic maintenance. Since dusty detectors are no longer able to detect any smoke, you always need a complete maintenance tool for the entire system at your fingertips.

6. Configuration Menu

Fireguard FG901CP_AP is also the dream of every installer: it is autoaddressable, with no need for time-wasting dip-switches or conventional programming devices.

7. Autoprogramming

The control panel reads the entire field and automatically programs all the devices. Next, the diagnostic map displays everything that's been programmed by the control panel. It's so simple!

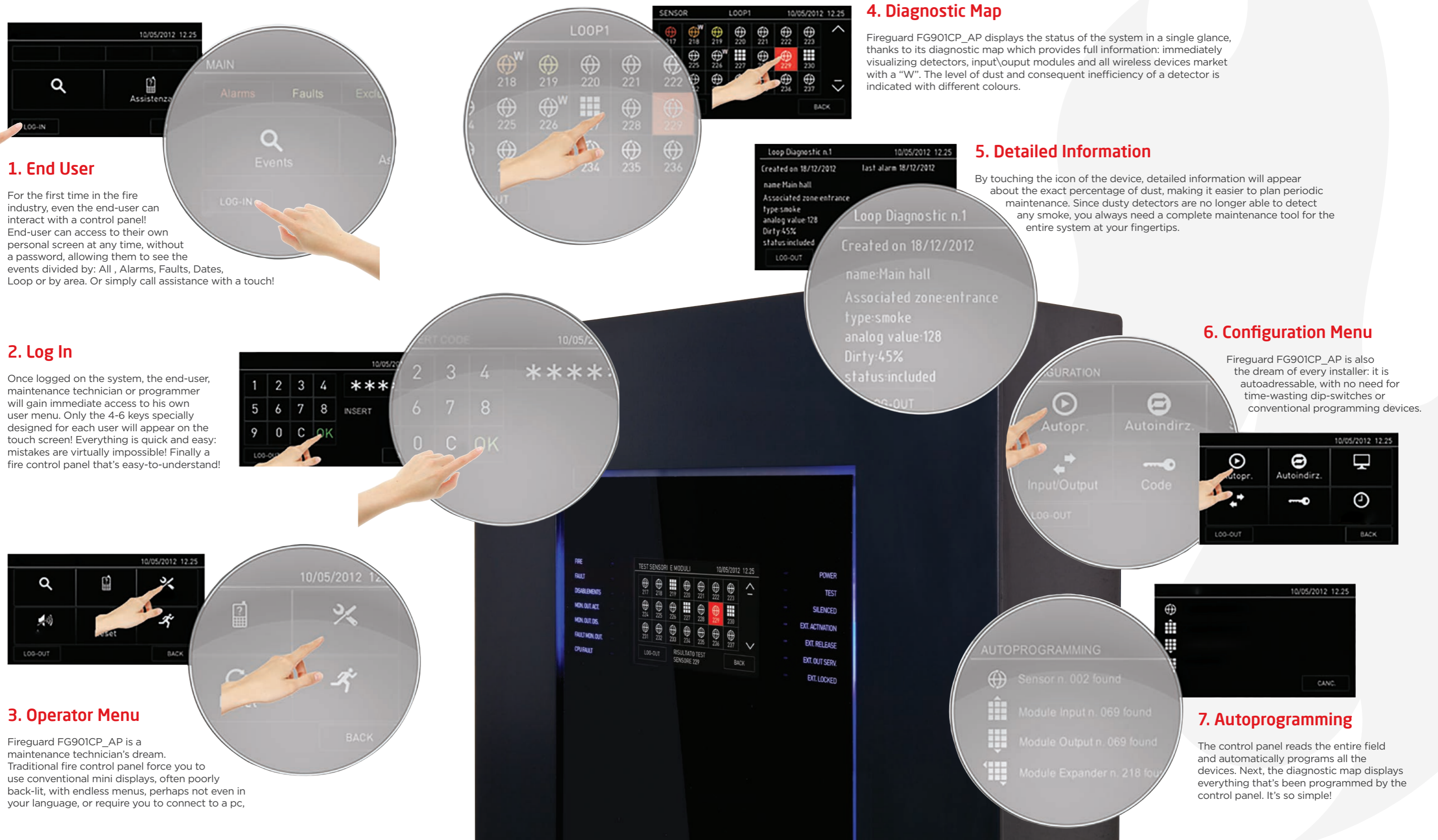



FG901LC_AP

Expansion card with 2 loops for FG901CP_AP

With FG901LC_AP you can extend the management capabilities of FG901CP_AP. One card has 2 supplementary loops, both have same features of master panel. The mounting is internal into fire alarm panel and doesn't modify the design.

Technical Features

- 2 loops
- up to 4 FG901LC_AP for one FG901CP_AP
- Certified device according to EN54-2
- Loop configurable as open or closed loop
- Maximum number of devices per loop: 240
- Internal mounting of the center by connector of the master board
- 2 programmable relay output of monitored alarm
- Multi - Protocol FIREGUARD Fireguard

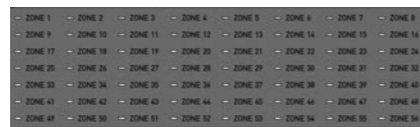

FG90156_LED_AP

Panel led for alarms of zones

Panel led FG90156_LED_AP is applicable below display of FG901CP_AP, without to modify form and design. Thanks to panel you can have a light signal of alarm of zones and will be possible individuate more fast the number of activate zone.

Technical Features

- number of visualizable zones 56
- Operating Temperature: -5 ° C/+ 40 ° C
- Dimensions: 219x58mm
- Red LED Color
- Powered by FG901CP_AP



FG901NC_AP

card for ring networks between FG901CP_AP

With FG901NC_AP you can connect in a ring network up to 128 FG901CP_AP, so is possible to create a system that shares all informations of each single panel.

Technical Features

- CAN BUS Connection
- speed communication up to 50 Kbps
- High fault tolerant, able in the presence of network failure, to maintain the necessary information pass between the nodes
- Compatible with central Olympia - FG901CP_AP
- Prepared for mounting inside the central FG901C_AP
- Range up to 1.2 km with a special cable
- Consumption 250mA max - 50mA nominal
- 12 Vdc power supply from the central Olympia
- 24 Vdc power supply from the central FG901CP_AP



FG901RP_AP

Remote Touch screen panel with iron case for FG901CP_AP and FG901CP-MINI_AP

Same as to the FG901CP_AP the FG901RP_AP is easy and intuitive to use. All functions can be reached with a touch according to the different levels of access. It offers the possibility of events and historical display.

Technical Features

- graphical touch screen display (480x272 TFT 4.3 ")
- 2 line RS 485 for the connection
- Operating Temperature: -5°C/+40°C
- Power supply: 27.6vdc
- consumption: 90mA
- Talk Speed: 38400 bps
- Maximum number of FG901RP_AP that can be connected to a control center: 14
- Dimensions: 210x120x30 mm
- Weight: 1kg
- Level of protection: IP30



PTLAN

Ethernet interface for FG901CP_AP

This card is a serial TTL interface powered by FG901CP_AP and mounted internally

Technical Features

- Powered by central
- From 300 to 900 kbps
- Control signals: RTS, CTS, DTR, DCD
- Ethernet 10 Base - T
- RJ45 connector
- Operating Temperature: -10C° to + 50°C°
- Dimensions: 45x90x28 mm

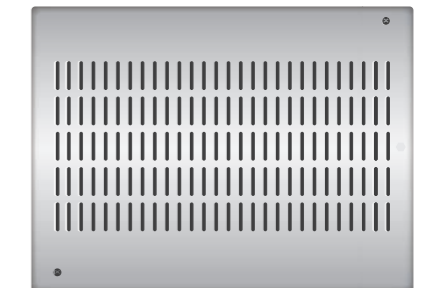

FG901MD_AP

Protocol converter for MODBUS protocol

Technical Features

- Unit microprocessor controlled 133 MHz
- 32Mbytes Flash expandable to 64Mbytes
- 32Mbytes Ram expandable to 64Mbytes
- Embedded Operating System
- Network interface card Ethernet 10/100 Base T Integrated
- 1 RS232 serial line protocol for interfacing with central IEC 79/5 - 79/6
- Internal battery backup
- Power supply: 12Vdc
- Power consumption: 480 mA
- Operating Temperature: 0° -50°
- Relative Humidity: 0% -95%
- Weight: 3,5Kg
- Dimensions: 208x152x65mm
- FUNCTIONAL
- Protocol converter on MODBUS RTU over TCP/IP or Modbus TCP/IP by RS232 serial CEI 79/5 - 79/6
- Prepared for future expansion and customization according to specific projects.



FG901PSU_AP

Auxiliary power supply for full configuration of FG901CP_AP

Must be use depending of the number of expansion card used.

Technical Features

- 100-240VAC Input - 1.2A
- 50/60 Hz
- output - 27V, 2.3A
- Operating Temperature: -5 ° C/+ 40 ° C
- Dimensions: 180x61x349mm

FDCANMONO

Mono mode optical fibre converter with ST connector for Olynet card

*on request

- Power supply: 12Vcc

FDCANMULTI

Multi mode optical fibre converter with ST connector for Olynet card

*on request

- Power supply: 12Vcc

FDSMART400 3g dialer EN54 21 certified *Q3 2017



Technical Features

- 4G dialer with Touch screen integrated
- Multilanguage interface
- Available protocols Contact ID, SIA(1/3 livelli) e Fast format (scancom)
- SMS message system interface
- 4 Input and 4 relè outputs
- Certified EN54 21, EN50136-2, EN50131-1& EN50136-1 (grado 2 e 3)
- Power and consumption 9-28Vdc 151mA
- Working temperature -10C + 55 C
- Size 110x150 mm

“Fireguard - safeguarding from hazardous fires, by designing, developing the latest technology products with high quality and reliability.”



FG901CP MINI_AP (Not networkable)
FG901CP MININET_AP (Networkable)
 1 loop addressable fire alarm control panel



FG901CP-MINISL_AP
 Addressable fire panel 1 loop
 Touch screen super light version

FG901CP-MINISL_AP is a microprocessor based fire detection panel that allows the detection of fires through wired or wireless devices and can be programmed and integrated through a fully touch screen interface.

The Mini Light panel, is able to manage an open or closed loop of 126 compatible devices

Certified to EN 54-2 and 54-4

The control panel can be programmed both locally and remotely, using the dedicated FG Cloud online platform

Suitable for small and medium installations



HARDWARE Features

- Addressable 32-bit microprocessor panel with graphical touchscreen display (480 x 272 TFT 4.3")
- 1 addressable loop with digital protocol configurable as open or closed
- 240 addressable devices on loop
- Up to 16 remote control panels can be connected to the RS485 BUS max 800m distance (cod. Art. FG901RP_AP)
- Short circuit protection
- 14 Front LEDs
- 2 monitored output for siren or optical-acoustic signaling (24Vdc 1A)
- General clean contact output 1A 30Vdc 120 Vac
- 1 general fault output
- 1 RS 485 for peripherals
- 1 RS 232/micro USB for programming and remote management.
- Ethernet card 10-100 Mbit/s (optional cod. Art. PTLAN)
- 16 LED zones
- Ring network adapter between panels (optional cod. Art. FG901NC_AP)
- Battery capacity: 2 x 7.2 Ah
- Efficiency test batteries and battery disconnection in case of deep discharge
- Operatin temperature from 0° to 50° degrees
- Auxiliary power output 24 Vdc 500mA with short protection
- Dimensions: 330 x 310 x 80 mm
- Power supply: 230Vac

SOFTWARE Features

- Up to 240 addressable devices for the loop
- hybrid yarms/radio
- Division up to 192 areas
- 96 logic functions
- Store more than 1000 events
- Auto programming analog devices on loop
- Auto addressing analog devices on loop
- Mapping analog devices on loop
- Ring connecting with other central using a fault tolerant network
- Multilingual management
- Fully customizable with personal logo, Color
- Touch screen and side multi-color LED
- Management of detectors and analog modules of different type
 - thermal and optical detectors mixed
 - Input Modules
 - Output Modules
 - buttons addressed
 - Analog Addressable sirens multiprotocol
- Selectable colored LED
- TCPIP Protocol MODBUS/MODBUS RTU over TCP IP (optional cod. Art. FG901MD_AP)
- Certified Product Standards EN54-2 and EN54-4

FG CLOUD

The new area of commissioning!

With FGCloud, the commissioning now is more innovative. The panels has different modes of programming capability, such as USB import , and direct programming from the touch screen; FG Cloud innovated cloud based programming, allowing the engineer to program the panel over the cloud saving time and visits to site.

Additional unique industry benefits of FG Cloud are:

- Same identical and user friendly GUI Interface of all the FIREGUARD panel range (It's not necessary to learn two different programming tool anymore)
- Full back up of all your customers vital programming
- Live remote support on the actual programming which would be installed on site (done with customer authentication sharing permission)

Everything free of charge!



Available expansion and accessories for FG901CP-MINI_AP

- FG901NC_AP
- FG901RP_AP
- PTLAN
- FG901MD
- FDSMART400

“FG Cloud innovated cloud based programming, allowing the engineer to program the panel over the cloud saving time and visits to site.”



FG901SHD_AP

Optical and thermal detector with short circuit isolator

It ensures an analysis of air condition and temperature of the protected area, and immunity to false alarms. The 360° visible LED with three different colours signals a condition of alarm (red), fault (yellow) and localization (green). Each detector is provided with an integrated isolator circuit, that automatically takes action in case of need.

The address can be programmed by means of the programmer or with the addressing function of FIREGUARD smoke detection panels.

It is provided with tools for base numbering and locking pin against unwanted removal.

Features

- Low profile thermal and thermovelocimetric smoke detector to be combined with FG901DB_AP
- Thermovelocimetric function at 58°C
- Thermal function at 78°C
- Built with multicolored plastic material, modern design.
- It can be programmed to operate at 58°C or 78°C
- Built with ABS plastic material with stabilized UV.
- Modern and compact design, low aesthetical impact
- Integrated self adapting function, to suit environmental changes
- Remote LED control option
- Power supply: 18-35V
- Average current consumption: 90 QA
- IP40 degree of protection
- Maximum current consumption remote LED: 15mA
- Operating temperature: -30°C + 70°C
- Max humidity: 95% non-condense
- Height: 48mm with base
- Diameter: 92mm
- Weight with base: 120g



FG901SHD1_AP

Thermal and thermovelocimetric detector with short circuit isolator

It ensures the analysis of the air temperature of the protected area and immunity to false alarms. The 360° visible LED with three different colours signals a condition of alarm (red), fault (yellow) and localization (green).

Each detector is provided with an integrated isolator circuit, that automatically takes action in case of need. The address can be programmed by mean of the programmer or with the addressing function of FIREGUARD smoke detection panels.

It is provided with tools for base numbering and locking pin against removal.

Features

- Low profile thermal and thermovelocimetric smoke detector to be combined with FG901DB_AP
- Thermovelocimetric function at 58°C
- Thermal function at 78°C
- Built with multicolored plastic material, modern design.
- It can be programmed to operate at 58°C or 78°C
- Built with ABS plastic material with stabilized UV.
- Modern and compact design, low aesthetical impact
- Remote LED control option
- Power supply: 18-35V
- Average current consumption: 90 QA
- IP40 degree of protection
- Maximum current consumption remote LED: 15mA
- Operating temperature: -30°C + 70°C
- Max humidity: 95% non-condense
- Height: 48mm with base
- Diameter: 92mm
- Weight with base: 120g



FG901SD1_AP

Optical detector with short circuit isolator

It ensures an analysis of air condition of the protected area, and immunity to false alarms. The 360° visible LED with three different colours signals a condition of alarm (red), fault (yellow) and localization (green).

Each detector is provided with an integrated isolator circuit, that automatically takes action in case of need. The address can be programmed by mean of the programmer or with the addressing function of FIREGUARD smoke detection panels. It is provided with tools for base numbering and locking pin against unwanted removal.

Features

- Low profile optical smoke detector to be combined with FG901DB_AP
- Built with ABS plastic material with stabilized UV.
- Modern and compact design, low aesthetical impact
- Integrated self adapting function, to suit environmental changes
- Remote LED control option
- Power supply: 18-35V
- Average power consumption: 90 QA
- IP40 degree of protection
- Maximum current consumption remote LED: 15mA
- Operating temperature: -30°C + 70°C
- Max humidity: 95% non-condense
- Height: 48mm with base
- Diameter: 92mm
- Weight with base: 120g



FG901MCP_AP

Addressable call point

Activation is signaled with a red led and glass break effect, the call point can be reset with the provided key.

Each call point is provided with integrated short circuit isolator that automatically takes action in case of need.

The address can be programmed by means of the programmer or with the addressing function of FIREGUARD smoke detection panels. It is provided with tools for base numbering and locking pin against unwanted removal.

Features

- Provided with integrated isolator circuit
- Red color led
- Flush-mounted installation tool included
- Power supply: 18-35V
- Average current consumption: 120 QA
- LED current consumption: 6mA (24V- line)
- Operating temperature: -20°C + 65°C
- Max. humidity: 95%
- Dimension: 87x87x54 mm
- Max. Cable cross section 2.5 mm



“The **FG901MCP_AP** is equipped with an integrated short-circuit isolator. This means that in the event of a failure on a loop or on a single device, communication with the devices themselves is not interrupted.”

FG-901PR_AP

WIRELESS HAND PROGRAMMER

The FG901PR_AP Unit allows to Program and display on the touch screen, the various stored parameters In Analog Devices Fire Read and set an analog address of a device, Read analog values and values of "dirty" Read the firmware version of a device Under Development: In next phase user would be able to interface to the programmer a Wired loop to analyze Earth Foul / Loop Cut / Voltage Level / Signal QualityAutodressing Future Development: Wireless Programming FG901PR_AP will be the first Wireless Hand programmer in the world.

Features

- Touch screen
- Wireless handheld programmer
- Pre stored parameters



“The **FG901PR_AP** first wireless hand programmer in the world.”

“The new series of analogue sensors of the **FG901 DETECTOR** range constantly monitor the fire alarm condition.”



FG901SI_AP

Addressable sounder EN54 3 with short circuit isolator

Sound emission can be manually adjusted on the sounder itself.

At the moment of activation, groups of sounders can be synchronized.

Each sounder is provided with integrated isolator circuit, that automatically takes action in case of need. Addresses can be programmed by means of the programmer or with the addressing function of FIREGUARD smoke detection panels.

Features

- Red plastic enclosure
- Provided with integrated isolator circuit
- Power supply: 19-30Vdc (per EN 54-3)
- Average power consumption: 120 QA
- Current consumption with operating sounder: 5-7mA (24V- line)
- Sounder output: 80 - 100dB
- Initiation tripping time: 2 sec
- IP degree: IP65
- Max. Cable cross section 2.5 mm2
- Operating temperature: -10°C /+55°C
- Max. humidity: 85% non condensing
- Dimensions: diameter 100mm height 92mm
- Weight: 190g



FG901SFI_AP

Addressable sounder EN54 3 with flashing light and short circuit isolator

Sound emission can be manually adjusted on the sounder itself.

At the moment of activation, groups of sounders can be synchronized. Each sounder is provided with integrated isolator circuit, that automatically takes action in case of need. Addresses can be programmed by means of the programmer or with the addressing function of FIREGUARD smoke detection panels.

Features

- Red plastic enclosure
- Provided with integrated isolator circuit
- Power supply: 19-30Vdc (for EN 54-3)
- Average power consumption: 120 QA
- Current consumption with operating sounder: 5-7mA (24V- line)
- Sounder output: 80 - 100dB
- Initiation tripping time: 2 sec
- IP degree: IP65
- Max. Cable cross section 2.5 mm2
- Operating temperature: -10°C /+55°C
- Max. humidity: 85% non condensing
- Dimensions: diameter 100mm height 92mm
- Weight: 190g



FG901SFI23_AP

Addressable sounder with flashing light EN54 3 and 23 and short circuit isolator

Sound emission can be manually adjusted on the sounder itself.

At the moment of activation, groups of sounders can be synchronized. Each sounder is provided with integrated isolator circuit, that automatically takes action in case of need. Addresses can be programmed by means of the programmer or with the addressing function of FIREGUARD smoke detection panels.

Features

- Red plastic enclosure
- Provided with integrated isolator circuit
- Power supply: 19-30Vdc (for EN 54-3)
- Average power consumption: 120 QA
- Current consumption with operating sounder: 30mA (24V- line)
- Sounder output: 80 - 100dB
- Initiation tripping time: 2 sec
- IP degree: IP65
- Max. Cable cross section 2.5 mm2
- Operating temperature: -10°C /+55°C
- Max. humidity: 85% non condensing
- Dimensions: diameter 95mm height 125mm
- Weight: 305g



FG901SB_AP

AVBASE Loop Power Sounder Base

FG901SB_AP Base Sounder operate over a wide input voltage range of 16 to 40V DC. The conventional range of detector base sounders are available in a standard 32 tone version in white with locally controllable output levels to enable the sound intensity to be adjusted to suit the application. This arrangement provides an extremely low-profile unit which is unobtrusive and protrudes only 28mm from the wall. The distinctive low-profile shape is acoustically very efficient, producing an omnidirectional high sound output at low current levels. Rugged construction with solid state electronics also provides high reliability and stable performance.

Features

- Ultra low current
- 4 volume levels
- Optical coverage level
- 32 primary tones
- 32 alternative tones
- Up to 92 dba



FG901SBFR_AP

AVBASE Loop Power Sounder Base and VAD Beacon

FG901SBFR_AP Base Sounder operate over a wide input voltage range of 16 to 40V DC. The conventional range of detector base sounders are available in a standard 32 tone version in white with locally controllable output levels to enable the sound intensity to be adjusted to suit the application and provide a synchronous LED flash rate 0.5Hz. This arrangement provides an extremely lowprofile unit which is unobtrusive and protrudes only 28mm from the wall. The distinctive low-profile shape is acoustically very efficient, producing an omnidirectional high sound output at low current levels.

Rugged construction with solid state electronics also provides high reliability and stable performance.

Features

- Ultra low current
- 4 volume levels
- Optical coverage level
- 32 primary tones
- 32 alternative tones
- Up to 92 dbA
- Synchronized flash



“The sirens of the FG901 SOUND series are equipped with an integrated short-circuit isolator conforming to the EN54-17 standard that means Guaranteed communication.”

“The distinctive low-profile shape is acoustically very efficient, producing an omnidirectional high sound output at low current levels. Rugged construction with solid state electronics also provides high reliability and stable performance.”



FG901MMI_AP

Input addressable module with short circuit isolator in Micro format

FG901MMO_AP

Output addressable module with short circuit isolator in Micro format

FG901MMIOS_AP

Input and output addressable modules with short circuit isolator in Micro format

Using these devices it is possible to interface the loop with different systems, or to activate, by means of output modules, any type of output (sounders, light signals, fire doors electromagnets, etc.). Reduced dimension permits device installation in any environment type.

Devices are provided with integrated short circuit isolator, and addresses can be programmed by means of the programmer or with the addressing function of FIREGUARD smoke detection panels.

Features

- Monitored input able to detect different thresholds
- Average current consumption: 120 QA
- LED current consumption: 6mA (24V- line)
- Provided with integrated isolator circuit
- Relay output: 30Vdc 2°
- Operating temperature: -30°C + 70°C
- Max. humidity: 95% non condensing
- Max. Cable cross section 2.5 mm
- Power supply: 18-35V
- Dimensions: 58x28x15 mm
- Weight: 13g

Using these devices it is possible to interface the loop with different systems, or to activate, by means of output modules, any type of output (sounders, light signals, fire doors electromagnets, etc.).

FG901MI3_AP

3 input addressable module with short circuit isolator

FG901MIO3_AP

3 input and 1 monitored output addressable module with short circuit isolator

FG901MI_AP

1 input, 1 C form output and 1 monitored output addressable with short circuit

FG901MIO2_AP

1 input, 2 C form output addressable module with short circuit isolator

Reduced dimension permits device installation in any environment type. Devices are provided with integrated short circuit isolator, and addresses can be programmed by means of the programmer or with the addressing function of FIREGUARD smoke detection panels.

Features

- Monitored input able to detect different thresholds
- Average current consumption: 120 QA
- LED current consumption: 6mA (24V- line)
- Provided with integrated short circuit isolator
- Relay output: 30Vdc 1A
- Operating temperature: -30°C + 70°C
- Max. humidity: 95% non condensing
- Max. Cable cross section 2.5 mm
- Power supply: 18-35V
- Dimensions: 106x54x27 mm
- Weight: 70g

FGpower power supply system

Power supply solution of FGpower series are a perfect power supply for all the devices of the area protected by the detection system.

They are in accordance with all EN54 regulations, they are fully monitored and certificated, and provided with switching technology.

They can be operated independently or connected with Bus RS485, to be then connected to One series control panels.

They are provided with thermo probe to modify charging voltage and adapt it to operating temperature.

They are able to check network presence, battery failure, faulty or low battery.



FGPOWER25_AP

2.5A power supply system

Features

- Input voltage: 85-264VAC
- Frequency range: 47-63Hz
- 2 power outputs, short circuit protected and with current limited to 4A.
- Monitored current consumption for each output
- Possibility to connect it with central BUS RS485 to monitor status
- Integrated and independent charger, with thermo probe to check battery temperature.
- Battery monitoring.
- Battery disconnection in case of low battery.
- 6 open collector outputs to report LOW BATTERY, MISSING BATTERY, CHARGER FAULT, OUTPUT OVERCURRENT, AC MAINS FAILURE, BATTERY FAULT
- Relay output to report generic faults.
- Internal switching feeding system from 3,2 A to 28V.
- Battery compartment for two 7Ah, 12V batteries.
- Dimensions (HxWxD): 297 x 285 x 80+8 mm.
- Weight (without batteries): 2,2 kg.

FGPOWERSO_AP

5A power supply system

Features

- Input voltage: 85-132VAC/179-264VAC by switch
- Frequency range: 47-63Hz
- 2 power outputs short circuit protected and with current limited to 4A.
- Current consumption monitored for each output.
- Possibility to connect it with central BUS RS485 to monitor status
- Integrated and independent charger, with thermo probe to check battery temperature.
- Battery monitoring.
- Battery disconnection in case of low battery.
- 6 open collector outputs to report LOW BATTERY, MISSING BATTERY, CHARGER FAULT, OUTPUT OVERCURRENT, AC MAINS FAILURE, BATTERY FAULT
- Relay output to report generic faults.
- Internal switching feeding system from 6,5 A to 28V.
- Battery compartment for two 7Ah, 12V batteries or for 26Ah 12V batteries.
- Dimensions (HxWxD): 375 x 420 x 182+8 mm.
- Weight (without batteries): 7,5kg.



“The **FGpower** power supply solution is perfect power supply for all the devices of the area protected by the detection system.”



FG EVAC 500_AP

EMERGENCY VOICE ALARM AND BACK GROUND MUSIC SYSTEM:

Audio Systems provide voice communication . The Audio Controller has built in two amplifier 500 watt with power supply charger 30 hours stand by + 30 minutes evac and provide Back up during master amplifier failed. Its Continues provide 2 simultaneous channels EVAC and Alert 10 minutes and optional 3x balanced audio input+2 Mixer. Digitized alarm tones and digitally recorded voice messages and message construction, and manages both multiple 8 button microphone and zone inputs and 3 audio inputs with 1 Mixer and 2 message player and 6 audio output PAVA over the speakers.

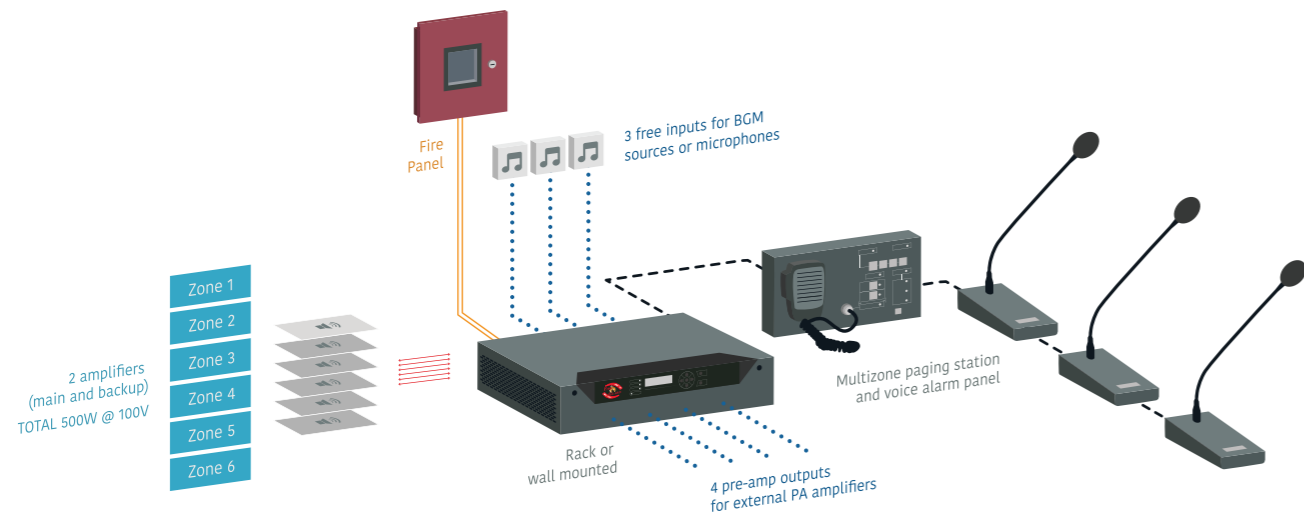

Connection for up to 10 equipment with double communication link. Up to 60 zones and speaker lines.

EXPANDABLE SYSTEM

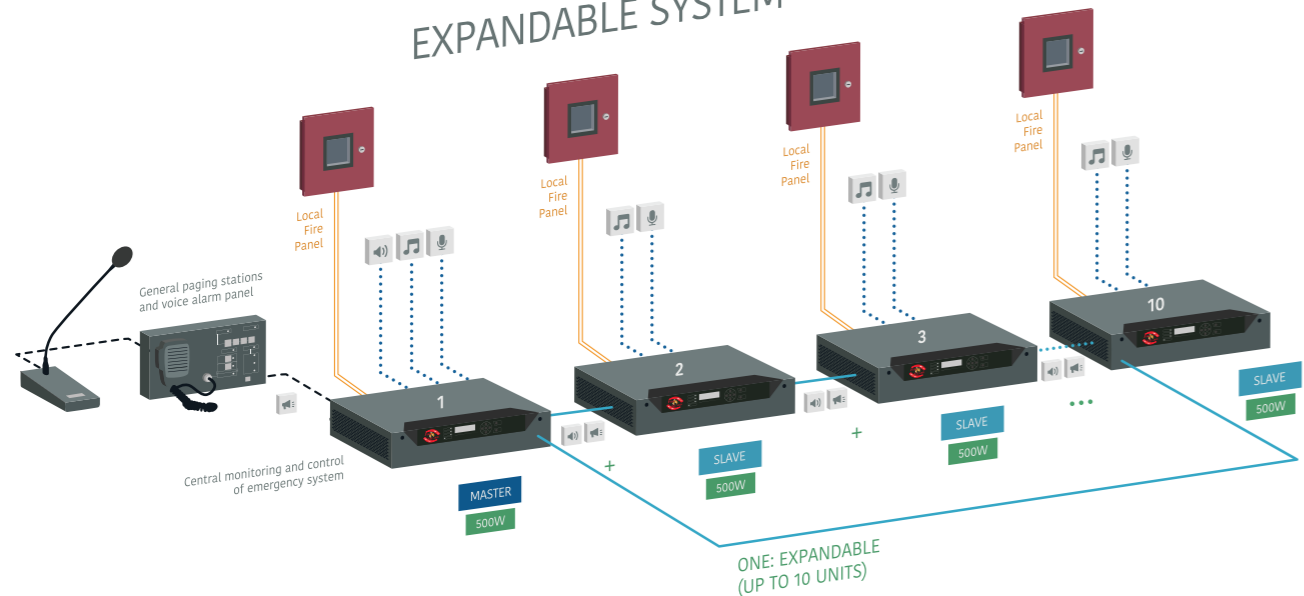

Connection for up to 10 equipment with double communication link. Up to 60 zones and speaker lines. EVAC and ALERT local messages + Autonomous emergency power supply for each ONE unit.

🎧 General audio source 🎵 Music audio local source (input 3) 🎤 Microphone local source priority (input 1) 📢 General paging stations and voice alarm panel

Addressable Fire Detection and Control Emergency Voice/Alarm Communications Equipment

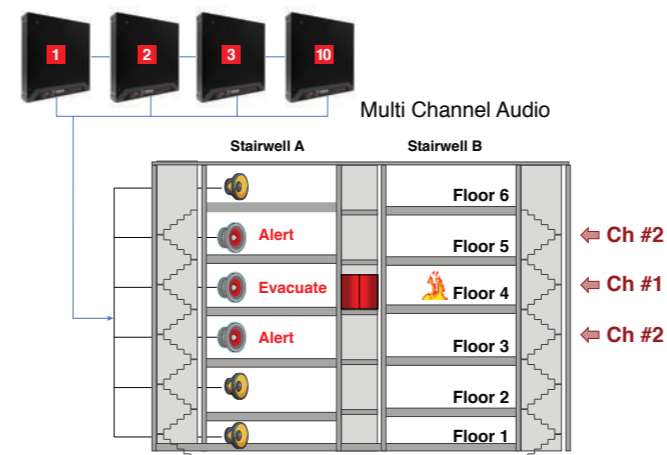
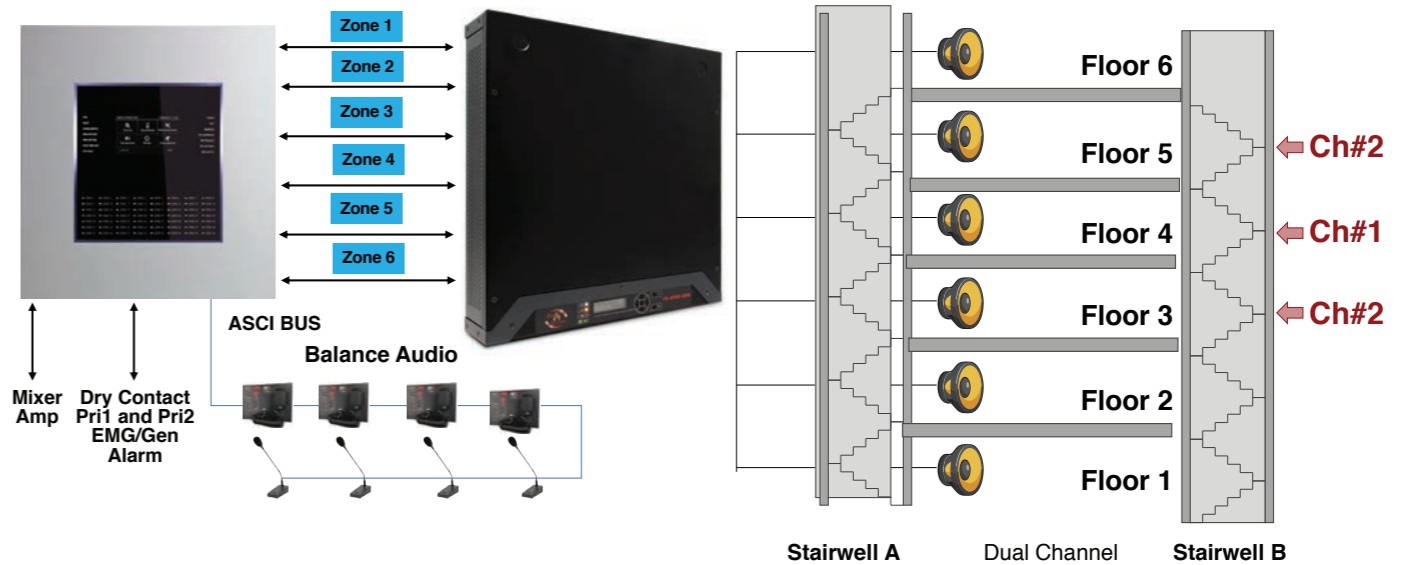

Automatic Alert/Evacuate message activated

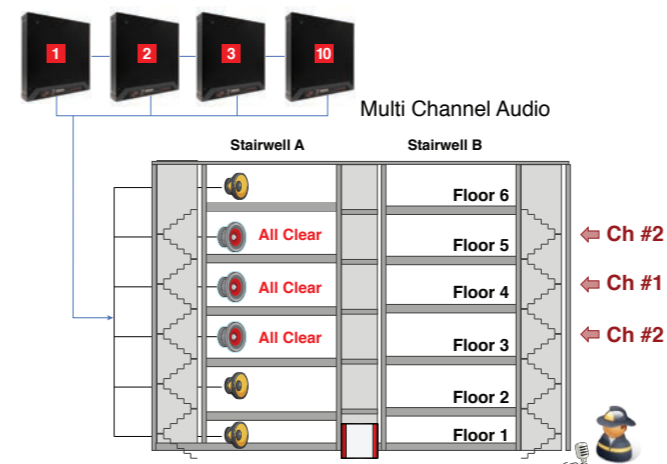

Manual voice all clear message by operator

Features

- Alarm/evacuation signal generation with multiple built-in messages
- Standard or customized digital message storage and message generation
- Automatic or manual operation
- Mass Notification operation Multiple channels are available:
- Audio systems provide dual channel operation
- Digital audio systems provide up to Multiple channels Audio output
- 3x audio balance Input and Dry contact to interface external Audio Source and MIC and 1x Mixer and 2 amplifier's output
- 1x Bus ACSI to interface 8 Voice alarm panel or 8x MIC or Mixed together up to 8 units.
- Up to 10x500 Watt Amplifiers can connect in RS485 to distribute in a group of floors .
- Each Amplifier support 6x Speakers zones to configure channel 1 EVAC and Channel 2 x Alert and phase evacuation other Speaker zones can be customised message . 3 Dry contact relay 1. General Alarm 2. Emergency
- Evac 3. 60 Zones alarm
- Recorded Audio Messages can be import from USB
- USB Back up and Restore
- Backup Amplifiers 500Watt
- Advanced integration Override output 24V, Attenuators, Flash light and 3rd party system
- 6x Audio Output 24V for Attenuator and Flash Lights and 4 x Pre-Amplifier output
- Fire Alarm integration with supervision
- Speakers line supervision
- Battery supervision
- Wiring Method A+B
- Wall Mount and Rack mount design



FG-BD100 Reflective Beam Detector

Product Overview

Reflective Beam Detector has built in Laser beam pointing and Digital guide display for real user friendly alignment method. The Laser beam pointing accurately point the exact location where to mount mirror and with additional digital guide display allows to monitor and guide on the actual light intensity between the mirror and detector which cannot be seen by our naked eye making it more easy and convenient in alignment commissioning.

FG-BD100 has four adjustable operational ranges between 8 to 20, 20 to 40, 40 to 70 and 70 to 100 metres beside with three adjustable sensitivity setting ranges from 2.6dB, 3.8dB and 5.8dB to meet the specific environmental requirement. FG-BD100 works on the principle of reflective infrared beam obscuration. Used in conjunction with a reflector, it will notify the fire alarm panel when the infrared beam is obscured by smoke.

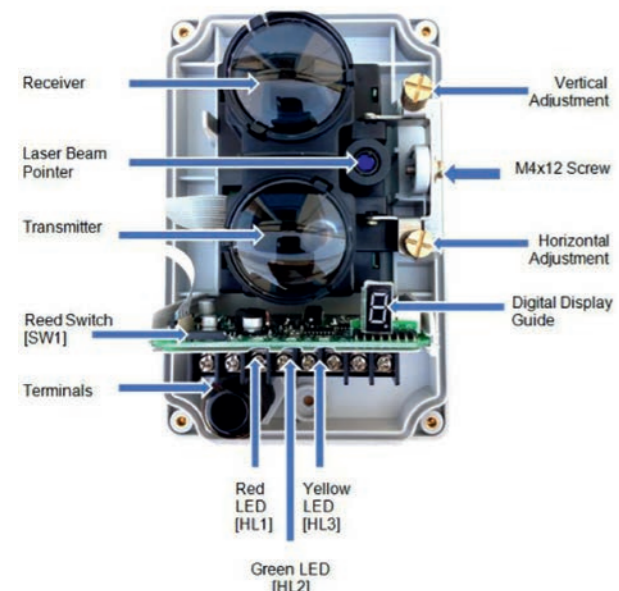

Features

- EN54-12 Compliance.
- Hassle free alignment, built with digital guide display and laser beam pointing.
- Employ single-ended design through reflective mirror.
- Four ranges wide monitoring from 8-100 meters via encoder.
- Built-in microprocessor.
- Self-diagnosis function can monitor for internal faults.
- Automatic compensation for factors weakening received signals, such as dust contamination, positional movement and ageing of the transmitter.
- Fire and Fault interfacing relays.
- Attractive and pleasing appearance.
- Real User friendly alignment method.

Technical Specification:

Standard

Listed : LPCB Approval.
Compliance : EN54-12
Fire Detection and Alarm Systems: BS 5839 Part 1 : 2002

Specification

Operating Voltage : 20 - 28 V DC
Current Parameters
Standby : 23 mA
Commission : 56 mA
Alarm : 33 mA

Beam Sensor Sensitivity [Via Encoder]

Level 1 : 2.6 dB High Sensitivity
Level 2 : 3.8 dB Medium Sensitivity
Level 3 : 5.8 dB Low Sensitivity

Beam Pathway Length [Via Encoder]

Span 1 : 8 to 20 meters Limited Path
Span 2 : 20 to 40 meters Short Path
Span 3 : 40 to 70 meters Normal Path
Span 4 : 70 to 100 meters Long Path

Beam Pathway Angle : 0.4° Directional.

Alignment Guide : Laser Beam Pointer

Digital Display Guide : Nixie Tube.

LED Indicator Guide

Red : Fire

Yellow : Fault

Green : Alignment

Reset Time : Less than 2 second

Relay Capacity [Fire & Fault] : Normally Open & close/ 2.0 A; 30 VDC

Physical

Material / Colour : ABS / White
Dimension(mm) / Weigh : L: 190.87 x W: 126.87 x H: 91.96 / 440g
Weight : 0.130 kg with base

Environmental

Operating Temperature : -10°C to +50°C
Ingress protection Rating : IP30 [IP66 glue seal-for permanent fixing]
Humidity : 0 - 95%



EN54-2 & EN54-4
1330a-(cl-4)

FG-SP5R_AP

EMERGENCY VOICE EVACUATION SPEAKERS

Voice Alarm ceiling loudspeaker is designed for flush in suspended ceiling and ideal for even sound distribution. The loudspeaker has a built-in protection to ensure that, in the event of a fire, damage to the loudspeaker does not result in failure of the loudspeaker circuit which is connected. In this way, system integrity is maintained and ensuring loudspeakers connected in the same circuit in other areas can still be used to inform people of the situation.

The loudspeaker can be easily installed by using the mounting spring attached. Likewise, the fire dome is mounted in the speaker openings on the ceiling panel by using the sliding brackets and the wing nuts as first-fix. FG-SP5R_AP is equipped with ceramic terminal blocks, thermal fuse and heat-resistant, high-temperature wiring to comply with EN54 part 24.

Features

- 5" Ceiling Loudspeaker
- Excellent sound reproduction
- Fire resistant cover with fire dome
- EN54-24 certified
- Available with or without capacitor(part number without "C")
- Rating 6 Watt Power Tapping 3 W / 1.5 W / 0.75 W / 0.375 W
- Intelligible voice and superior sound reproduction
- Robust metal enclosure
- Harmonious with all indoor decoration
- Simple power setting
- Easy installation
- Complies with EN54-24 standard
- Power rating 9W
- Power Tapping 6 W / 3 W / 1.5 W / 0.75 W



FG-SP4W_AP

EMERGENCY VOICE EVACUATION SPEAKERS

This loudspeaker is a high-performance 6 W voice alarm cabinet loudspeaker. It provides a broad frequency response range, low distortion and high sound pressure level for accurate and intelligible broadcast of evacuation messages and high quality sound reproduction. It's ideal for sound distribution in various types of commercial buildings. Its low-profile, white color design blends easily with most interiors in locations such as hotels, conference rooms, cinemas, factories and exhibitions.

This voice alarm cabinet loudspeaker complies with BS5859 part 8 and EN54 part 24.

Features

- Intelligible voice and superior sound reproduction
- Robust metal enclosure
- Harmonious with all indoor decoration
- Simple power setting
- Easy installation
- Complies with EN54-24 standard





“Fireguard aims to be customer’s first choice to safeguard from hazardous fires, by designing, developing the latest technology products with high quality and reliability.”

FIREGUARD GLOBAL LTD.

Tel: 00-44-8450751042
 Fax: 00-44-8459751043
 Email: Info@Fireguard-Uk.com
 www.fireguard-Uk.com



Unit 11 · Chancel Industrial Estate · Newhall Street
 Willenhall · WV13 1NX · United Kingdom

